



## Armoured Aerial Figure 8 Fiber Optic Cable GytC8s 8 Cores Outdoor

Our Product Introduction

for more products please visit us on [fiberoptical-cables.com](http://fiberoptical-cables.com)

### Basic Information

- Place of Origin: GUANGZHOU/CHINA
- Brand Name: PUNAI SGD/CABLEPULS
- Certification: ISO/CE/ROSH
- Model Number: GYTC8S-8B1.3
- Minimum Order Quantity: 2km
- Packaging Details: Wooden Spool /drum
- Delivery Time: 5-25days
- Payment Terms: 30%TT as deposit,70%Balance before shipping.
- Supply Ability: 100km



### Product Specification

- Item NO.: GYTC8S-8B1.3
- TYPE: Fig.8 Shape
- Application: Outdoor AREIAL
- Jacket Material: PE/LSZH
- Fiber Type: G.652D
- Strength Member: Messenger Wires
- Outer Diameter: 8.5\*12.5mm
- Warranty Period: 25 Years
- Highlight: Armoured Aerial Figure 8 Fiber Optic Cable, Aerial Fiber Optic Cable 8 Cores, GytC8s Aerial Fiber Cable

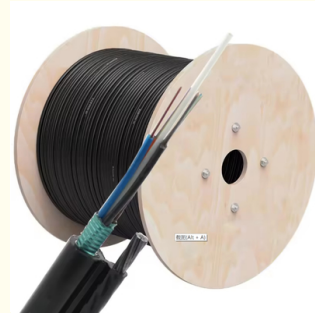

### More Images

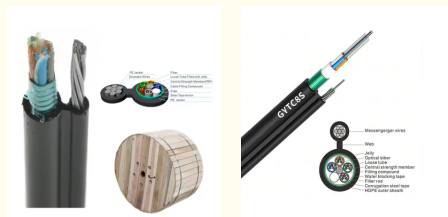

### Product Description

#### Aerial Figure.8 Fiber Optic Cable GytC8s 8 Cores ARMoured OUTDOOR OPTICAL FIBRE Cable

figure 8 outdoor Fiber optic cable GYTC8S GYTC8A GYTC8Y, 2~144 fibers, metal steel strand central strength member, jelly filled, fiber contained loose tube and PP filler stranded, water blocking jelly, longitudinally covered by copolymer coated steel tape (GYTC8S), APL (GYTC8A), water blocking tape GYTC8Y, PE outer sheath, fig 8 type, 7 steel wires stranded as supporting wire. G652D SM fiber, detailed on your request.

Our Product Introduction

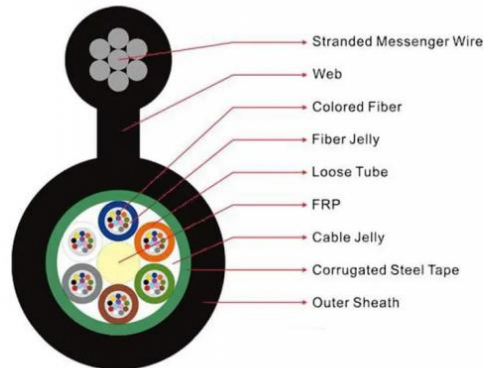

#### Technical data:

Numbers of fibers: **6-8,10-12,14-24,30-72**  
 Design(Strength Member+Tube&Filler): **Central Steel wires+Stranded Loose Multi-tube Cable**  
 Fiber type: **Single mode G.652.D**  
 Strength Member: **PSP**  
 Loose Tube: **PBT**  
 Filler Rope: **No**  
 Water Blocking Layer(Material): **Water Blocking tape**  
 Additional Strength Member(Material): **PSP**  
 Outer Sheath: **PE**  
 Cable Diameter( $\pm 0.2\text{mm}$ ): **6.8\*9.2\*18mm;7\*9.5\*18.5mm**  
 Cable Weight( $\pm 10.0\text{kg/km}$ ): **210-250kg**  
 Attenuation coefficient : **@ 1310nm  $\leq 0.35\text{dB}$  ; @ 1550nm  $\leq 0.2\text{dB}$**   
 Min. bending radius Without Tension: **10.0\*Cable- $\phi$**   
 Min. bending radius Under Maximum Tension: **20.0\*Cable- $\phi$**

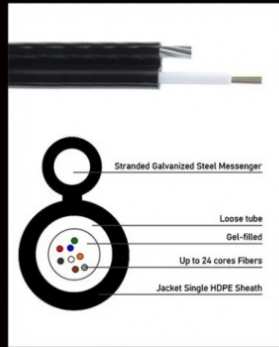

Model: GYTC8Y  
 Messenger: 1.5mm Standed Galvanized Steel  
 Messenger for Flexibility  
 Fiber : Up to 24 cores, Gel filled  
 Jacket: Single HDPE Sheath  
 Armor: None  
 Tension Strength: 1000(Short term)  
 300(Long term)  
 Cable Diameter: 5.1\*10.2mm  
 Package: 4km/drum  
 Weight: 47KG/KM

Model: GYTC8S  
 Messenger: 1.5mm Standed Galvanized Steel  
 Messenger for Flexibility  
 Fiber : Up to 24 cores, Gel filled  
 Jacket: Single HDPE Sheath  
 Armor: Steel Tape  
 Tension Strength: 1000(Short term)  
 300(Long term)  
 Cable Diameter: 7.6\*14.5mm  
 Package: 4km/drum  
 Weight: 117KG/KM

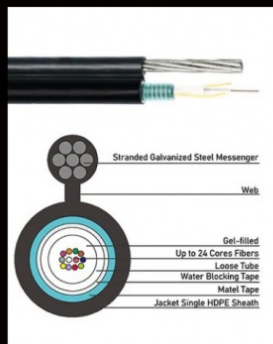

Model: GYTC8Y

Messenger: 7\*1.0mm Standed Galvanized Steel

Messenger for Flexibility

Fiber : Up to 288 cores, Gel filled

Jacket: Single MDPE Sheath

Water Block: Water Blocking or Gel-filled

Armor: None

Tension Strength: 3000(Short term)  
1000(Long term)

Cable Diameter: 9.1\*16.9mm

Package: 4km/drum

Weight: 142KG/KM

Model: GYTC8S

Messenger: 7\*1.0mm Standed Galvanized Steel

Messenger for Flexibility

Fiber : Up to 288 cores, Gel filled

Jacket: Single MDPE Sheath

Water Block: Water Blocking or Gel-filled

Armor: Steel Tape, Thickness 1mm

Tension Strength: 3000(Short term)  
1000(Long term)

Cable Diameter: 9.5\*17mm

Package: 4km/drum

Weight: 156KG/KM

GYTC8S Cable Place Order Information

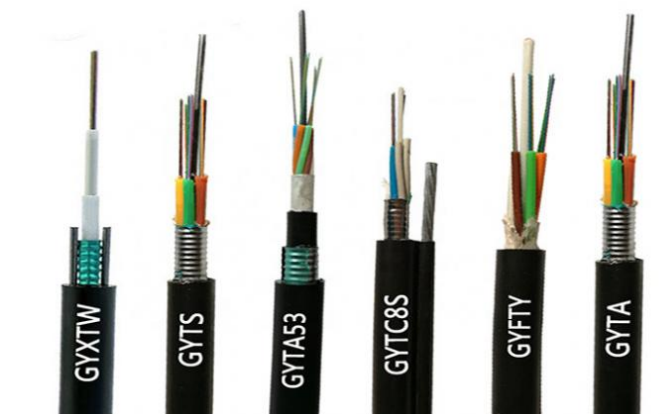

CABLE DATA		
No. of cable		12 24
Fiber Model		G652D
Design (StrengthMember+ Tube&Filler)		1+5
Central Strength Member	Material	FRP
	Diameter(±0.05)mm	1.5
	Material	PBT
Loose Tube	Diameter(±0.06)mm	1.7
	Thickness(±0.03)mm	0.32
	The Max.Core NO./Tube	6
Filler Rope	Material	PP
	Diameter(±0.06)mm	1.7
	NO.	3   1
Water Blocking Layer( Material)		Flooding Compound
Outer Sheath	Material	PE
	Thickness(±0.1)mm	1.2
Outer Sheath	Material	PE
	Thickness(±0.1)mm	1.8
Web	Material	PE
	Size(±0.1)mm	2.0*2.0
Messenger Wire	Material	Steel stranded
	Size(±0.1)mm	2.7mm(0.9mm×7)
Cable Diameter(±0.5)mm(W×H)		8.5x15.2
Cable Weight(±10)kg/km		100
Min. bending radius	Without Tension	10.0×Cable-φ
	Under Maximum Tension	20.0×Cable-φ
Temperature range ( )	Installation	-20~+60
	Transport&Storage	-40~+70
	Operation	-40~+70

Cable Marking&Fibers Colors

COMPANY Fiber cable name N\*cores G.652D 2024 XXXXm

\*The marking is printed every 1 meter;

\*\*\*G.652D" means ITU-T Rec. Low Water Peak (LWP) G.652 single mode optical fiber..

Also can according to client cable marking.

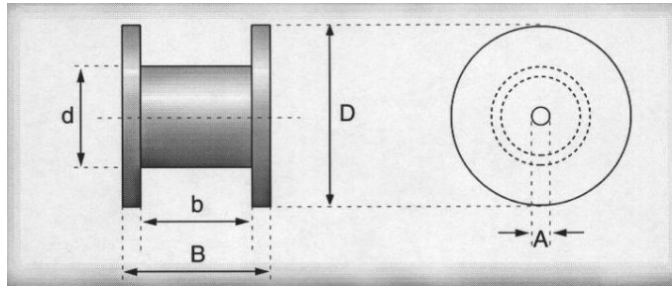

## Production Supplier Profile



### COMPANY PROFILE



### ABOUT FIBER

Guangzhou fiber cablepuls co.,ltd

Fiber cablepuls is one of the high-tech fiber optic cable factories in China that can produce the most complete series of fiber optic cables, equipped with the most advanced fiber optic cable manufacturing, and have the most advanced fiber optic connector production and testing equipment in China.

The factory has obtained SGS ISO9001:2015, ISO14001:2004 and GB/T28001:2001 successively obtained international system certification.

Over the past 12 years, we have provided optical cable products and comprehensive solutions to more than 90 countries and regions around the world, and have received unanimous praise from customers, such as foreign telecom departments of the United States, Mexico Telecom, Thailand Telecom, Philippines Telecom, etc., domestic customers include: China Mobile, the General Administration of Radio, Film and Television, Lenovo, and many other large national enterprises.



+8613687956390

cotton@fibercabl



## OUR PRODUCTION CAPACITY AND QUALITY CONTROL SYSTEM



### How do I place an OEM or customized order?

- 1) Send your purchase intention to our email: [cotton@fibercablepuls.com](mailto:cotton@fibercablepuls.com)
- 2) Our sales team will contact you to confirm the product specification, packaging, printing, quantity, and other specific information.
- 3) Sign the contract or Proforma Invoice.
- 4) After receiving your deposit, we will start to arrange the production.
- 5) 2 weeks before the completion of production, we will notify you to start contacting shipping.

925-926, Building B1, No. 2 Chuanghui Avenue, Yonghe Yushan International Guangzhou city, Guangdong province, China